

## TABLE OF CONTENTS

Table of Contents	1
Show Timetable	2
Welcome	3
Committee Chairmen	4
General Rules	5
Standard System of Awarding	6
NGC Top Exhibitor Awards being offered	6
Division I: Horticulture	7
Horticulture Division I Rules	7 - 8
Horticulture Division Sections and Classes	9 – 11
Division II: Education Division	12
Division III: Youth/Sponsored Groups	13
Division IV: Botanical Arts	14

## SHOW TIMELINE

### **Pre-registration Begins**

Botanical Arts Division

January 31, 2023

Horticulture Division

March 1, 2023

### **Pre-registration Deadline**

April 1, 2023

### **Show Set Up/Staging**

April 21, 2023 (Friday)

Horticulture Division

8:00 AM – 11:00 AM

Botanical Arts, Education, &  
Youth Divisions

2:30 PM – 3:00 PM

### **Exhibits Entered**

April 21, 2023 (Friday)

Horticulture Division

11:00 AM – 1:00 PM

Botanical Arts, Education, &  
Youth Divisions

3:00 PM – 5:00 PM

### **Judging**

April 22, 2023 (Saturday)

Judges Breakfast & Briefing

8:00 AM – 9:00 AM

Judging Commences

9:00 AM

Judges Luncheon

11:30 AM

### **Show Open to Public**

April 22, 2023 (Saturday)

11:30 AM – 4:00 PM

### **Show Dismantled**

April 22, 2023 (Saturday)

All Entries Removed

4:00 PM – 5:00 PM

Show Teardown

5:00 PM – 6:00 PM

## WELCOME

Welcome to 'Earth Day ... Every Day', our NGC Horticulture Specialty Flower Show. Participants of all ages will join garden club members in this delightful and educational experience.

Our mission today and every day is to educate and support you and our members to become stewards of the earth. Our exhibits will include Horticulture, Botanical Arts, Youth, and Education. We hope to inspire you to share our enthusiasm for all things green and growing and to make 'Earth Day ... Every Day'.

We want to thank all the Wellington Garden Club members who have shared their time and expertise to make this a fun and educational event.

We are especially grateful for the support and assistance we received from the staff at the Wellington Community Center as we prepared for this show. Thank you also to the Village of Wellington for their continued commitment to the sustainable growth of our community and their promise to make 'Earth Day ... Every Day', today and for future generations.

We hope a seed has been planted in you today, that will grow into a beautiful lifelong commitment to make 'Earth Day ... Every Day' in your lives and the lives of those you love.

Thank You  
Wellington Garden Club



## COMMITTEE CHAIRMEN

<b>Club President</b>	Maria Wolfe	561-386-4903	<a href="mailto:tcacad_registrar@yahoo.com">tcacad_registrar@yahoo.com</a>
<b>General Chairman</b>	Caroline Kessman	561-324-8320	<a href="mailto:ckessman@gmail.com">ckessman@gmail.com</a>
<b>Schedule Chairman</b>	Susan Hillson	561-333-0740	<a href="mailto:susan.hillson@gmail.com">susan.hillson@gmail.com</a>
<b>Staging/Properties Chairmen</b>	Christine Biscoglio Linda DeSanti	631-793-5349 561-758-7415	<a href="mailto:2usnow@comcast.net">2usnow@comcast.net</a> <a href="mailto:gdesanti@bellsouth.net">gdesanti@bellsouth.net</a>
<b>Horticulture Placement Chairman</b>	Bobbi Ziegler	561-422-7005	<a href="mailto:bobbironz@gmail.com">bobbironz@gmail.com</a>
<b>Horticulture Entries Chairmen</b>	Stormi Bivin Petra Russell	561-352-0129 561-398-5588	<a href="mailto:sbivin@aol.com">sbivin@aol.com</a> <a href="mailto:redede2enjoylife@gmail.com">rede2enjoylife@gmail.com</a>
<b>Education Division Chairman</b>	Twig Morris	561-434-6629	<a href="mailto:twig_morris@hotmail.com">twig_morris@hotmail.com</a>
<b>Youth Division Chairmen</b>	Kathy Schneider Janet Stein	513-545-4981 561-684-2135	<a href="mailto:kathyschneider1@comcast.net">kathyschneider1@comcast.net</a> <a href="mailto:jrstein@bellsouth.net">jrstein@bellsouth.net</a>
<b>Botanical Arts Chairman</b>	Carol Lazzarino	561-312-2082	<a href="mailto:clazzar586@aol.com">clazzar586@aol.com</a>
<b>Classification Chairmen</b>	Barbara Zenker Uma Bhatti	561-795-3675 561-795-4144	<a href="mailto:barbzzz@msn.com">barbzzz@msn.com</a> <a href="mailto:uma1131@aol.com">uma1131@aol.com</a>
<b>Judges Chairman</b>	Barbara May	781-929-6504	<a href="mailto:maydesign4521@gmail.com">maydesign4521@gmail.com</a>
<b>Judges Luncheon</b>	Anne Hlasnicek	561-793-7290	<a href="mailto:srsrnick@bellsouth.net">srsrnick@bellsouth.net</a>
<b>Clerks Chairman</b>	Ronnie Levay	703-930-8490	<a href="mailto:lslusship@aol.com">lslusship@aol.com</a>
<b>Awards Chairman</b>	Carol Dima	917-873-3571	<a href="mailto:cdqu@aol.com">cdqu@aol.com</a>
<b>Publicity Chairmen</b>	Twig Morris Paige Griffin	561-434-6629 561-310-5119	<a href="mailto:twig_morris@hotmail.com">twig_morris@hotmail.com</a> <a href="mailto:agri349229@aol.com">agri349229@aol.com</a>
<b>Hospitality Chairmen</b>	Huguette Damas Linda Messina	610-737-2722 561-512-5638	<a href="mailto:huguette.damas@gmail.com">huguette.damas@gmail.com</a> <a href="mailto:lmessina5@aol.com">lmessina5@aol.com</a>

## GENERAL RULES

1. This Flower Show conforms to the standards established by National Garden Clubs, Inc. (NGC). *The Handbook for Flower Shows* (HB), 2017 edition, with revisions posted on the NGC website, is the authority for all issues not covered by the schedule, which is the Law of the Show.

2. Entries in the Horticulture, Education, and Botanical Arts Divisions are open to Wellington Garden Club members or by invitation. The Youth Division is open to the Junior Garden Clubs at Greenacres Elementary School and the Wellington Boys and Girls Clubs.

3. Advance registration is required for the Horticulture, Education, and Botanical Arts Divisions by April 1, 2023.

Horticulture Division Entries Chairmen, Stormi Bivin, 561-352-0129, [sbivin@aol.com](mailto:sbivin@aol.com) and Petra Russell, 561-398-5588, [rede2enjoylife@gmail.com](mailto:redede2enjoylife@gmail.com)

Education Chairman, Twig Morris, 561-434-6629, [twig\\_morris@hotmail.com](mailto:twig_morris@hotmail.com).

Botanical Arts Chairman, Carol Lazzarino 561-312-2082, [clazzar586@aol.com](mailto:clazzar586@aol.com)

4. Entry cards are available from the Chairman for each Division on March 1, 2023.

5. Exhibitors are to fill out entry cards in advance (typed, in water-proof ink, with labels, or in pencil).

6. Entries will be accepted on Friday April 21, 2023 at the Wellington Community Center at: Horticulture Division 11:00 AM – 1:00 PM Education, Botanical Arts, and Youth Divisions 3:00 PM – 5:00 PM.

7. All exhibits must be removed on Saturday April 22, 2023 from 4:00 PM – 5:00 PM.

8. Judging will begin on Saturday April 22, 2023 at 9:00 AM.

9. The Classification Chairmen or Chairman for each Division checks exhibits for conformity to the schedule prior to judging. Final determination for conformance is the judges' responsibility. (HB Pg. 24)

10. The General Chairman and the Classification Chairmen for each Division are available during judging for possible consultation. They, along with the Judges and Clerks, are the only personnel allowed on the floor during judging. (HB Pg.25)

11. The decisions of the judges are final. Awards may be withheld if not merited. (HB Pg.25)

12. There must be an emphasis on FRESH plant material; no artificial plant material is permitted in any exhibit in any Division. (HB Pg.25)

13. The Wellington Garden Club will strive to assure the safety of all items after arrival and placement but is not responsible for any loss or damage to exhibits. (HB Pg. 25)

14. Native plant material, correctly labeled and legally obtained within the state of Florida may be entered and displayed. The use of plant material classified as Invasive Exotic or Aquatic Invasive is prohibited. See the IFAS website at the Center for Aquatic and Invasive plants, [www.plants.ifas.ufl.edu](http://www.plants.ifas.ufl.edu) for a complete list.

## AWARDS

### THE NGC STANDARD SYSTEM OF AWARDING

The NGC Standard System of Awarding (HB pg. 5) is used in all Divisions.

Only one (1) first-place (blue) ribbon per class or subclass; must score 90 points or more.

Only one (1) second-place (red) ribbon per class or subclass; must score 85 points or more.

Only one (1) third-place (yellow) ribbon per class or subclass; must score 80 points or more.

One (1) or more honorable mention (white) ribbons as merited; must score 75 points or more.

### NGC TOP EXHIBITOR AWARDS

#### Horticulture Top Exhibitor Awards:

Award of Horticultural Excellence (Division Award) (HB Pg. 40) One is offered to the highest scoring, correctly named, blue ribbon winner, scoring 95 or above in the entire Horticulture Division. Rosette of Green, Orange, and Blue ribbons

Arboreal Award (HB Pgs. 40-41) One is offered to the highest scoring, correctly named, blue ribbon winner, scoring 95 or above meeting all section requirements in Section E, classes 28-37. Rosette of Green Ribbons

Award of Merit (HB Pg. 41) One is offered to the highest scoring, correctly named, blue ribbon winner, scoring 95 or above meeting all section requirements in Section D, classes 19-27. Rosette of Orange Ribbons

Grower's Choice Award (HB Pg. 41) Four awards are offered to the highest scoring, correctly named, blue ribbon winner, scoring 95 or above meeting all section requirements. One in Section A, classes 1-8. One in Section B, classes 9-14. One in Section C, classes 15-18. One in Section F, classes 38-40. Rosette of Dark Green Ribbons

#### Education Division Top Exhibitor Awards:

Educational Top Exhibitor Award (HB Pgs. 43-44) Only one may be offered to the highest scoring, blue ribbon exhibit, scoring 95 or above, entered by one or more exhibitors. Minimum of 2 exhibits. Rosette of Brown and White Ribbons

#### Youth Division Top Exhibitor Awards:

Youth Division Top Exhibitor Award (HB Pg. 44) Two awards are offered to the highest scoring, blue ribbon exhibit, scoring 90 or above, in Horticulture. No minimum number of exhibits required. One in Section A classes 1-5. One in Section B classes 6-11. Rosette of Red, white, and blue ribbons

#### Botanical Arts Top Exhibitor Awards: (Section Award)

Botanical Arts Horticulture Award (HB Pg. 44) One award is offered to the highest scoring blue ribbon winner, scoring 95 or above meeting all section requirements in Section A, classes 1,2,3. A minimum of twelve exhibits combined required for classes 1,2,3. Rosette of light brown ribbons.

## **DIVISION I HORTICULTURE**

### **“Planting with a Purpose”**

*Eligible for Award of Horticultural Excellence*

*In addition to absorbing carbon dioxide and releasing oxygen through photosynthesis certain indoor plants remove harmful toxins (benzene, formaldehyde, and trichloroethylene). The NASA Clean Air Study 1989*

### **HORTICULTURE RULES**

1. The NGC exhibit policies are printed in the ‘Handbook for Flower Shows’, Chapter 6, Exhibiting in The Horticulture Division. (HB Pg. 27)
2. All exhibits must be FRESH. Dried and preserved specimens may be entered in the Botanical Arts Horticulture Division.
3. All exhibits must have been grown by the exhibitor.
4. Plant material must be in its natural state and may not be altered by application (treatment) of oil, commercial “shine” products, etc., that change the natural appearance. No wiring of specimens is permitted.
5. Only foliage and/or flowers naturally grown and still attached to the specimen are permitted in the Flower Show. Unattached foliage is never included with a cut bloom specimen.
6. All plant material must have been in the possession of the exhibitor for the appropriate number of days listed in the chart (HB Pg. 55). Annuals, perennials, houseplants, fruits, and vegetables for at least ninety (90) days. Exceptions: Arboreal – woody specimens – six (6) months; Early maturing crops such as lettuce, radishes, etc. – no minimum; Combination plantings, except troughs – six (6) weeks; Troughs – six (6) months.
7. The rules for single species, cut or container-grown specimens are listed in the ‘Handbook for Flower Shows’ or its supplement, ‘Horticulture Exhibiting and Judging’.
8. In order to receive an NGC Top Exhibitor Award, the Exhibitor must identify his/her entry by its binomial name or currently acceptable scientific designation. NGC recognizes [www.plantsoftheworld.org](http://www.plantsoftheworld.org) as the authority for naming horticulture

specimens. (Consult 'Handbook for Flower Shows', Exhibiting in The Horticulture Division, Chapter 6.) (HB Pg.27) .

9. Advance registration is required by April 1, 2023 with the Horticulture Division Entries Chairmen, Stormi Bivin, 561-352-0129, [sbivin@aol.com](mailto:sbivin@aol.com) and Petra Russell, 561-398-5588, [redenjoylife@gmail.com](mailto:redenjoylife@gmail.com) Entry forms are available on the WGC Website, [wellingtongardenclub.org](http://wellingtongardenclub.org) and from the entries chairs.
10. Entry cards are to be filled out in advance if possible and should be written in waterproof ink. Refer to the 'Handbook for Flower Shows', Chapter 6, for a correctly filled out entry card. (HB Pg. 57)
11. Cut specimens should not have foliage below the water line, except for Gladiolus.(HB Pg.27).
12. If a plant is considered a flowering plant, it should be exhibited as a flowering specimen. Foliage plants may flower but, should be exhibited as foliage plants if they are grown for their leaves.(HB Pg.27)
13. Specimens with a class designation in the schedule may not be entered in the 'Any Other Worthy' class.(HB Pg.27)
14. The Horticulture Classification Committee Chairman and/or General Show Chairman are free to subdivide classes by color, form, size, cultivar, variety or other distinguishing characteristics. (HB Pg.27)
15. The Scales of Points for Horticulture are located in Chapter 14 of the 'Handbook for Flower Shows'.
16. Clear glass containers will be supplied by the flower show committee for cut specimens. Wedging with plastic wrap will be allowed.
17. Double-potting is allowed. Inner pot must not be visible. Clean, neutral-colored containers with saucers are preferred for container grown plants.
18. All exhibits (except hanging plants) will be staged on tables 6' or 8' long X 30" wide X 29" high covered with black tablecloths
19. Exhibitor may enter more than one exhibit per class or sub-class if each is of a different genus, species, variety, type, form, size, or color.



## **DIVISION I HORTICULTURE**

### **SECTIONS AND CLASSES**

#### **SECTION A: CONTAINER GROWN FOLIAGE PLANTS “Houseplants that Clean the Air”**

Maximum container size 12”, Maximum weight 20 lbs.

*Eligible for Grower’s Choice Award*

Class 1: *Aglaonema commutatum* (Chinese Evergreen)

Class 2: *Aloe barbadensis miller* (Aloe Vera)

Class 3: *Bromeliaceae* (Bromeliad)

Class 4: *Dieffenbachia* (Dumb Cane)

Class 5: *Dracaena* (including *Sansevieria*)

Class 6: *Maranta leuconeura* (Prayer Plant)

Class 7: *Zamioculcas zamiifolia* (ZZ Plant)

Class 8: Any other worthy specimen

#### **SECTION B: CONTAINER GROWN FLOWERING PLANTS or PLANTS WITH COLORFUL BRACTS “Indoor Air Purifiers”**

Maximum container size 12”, Maximum weight 20 lbs.

*Eligible for Grower’s Choice Award*

Class 9: *Anthurium andraeanum* (Flamingo Flower)

Class 10: *Begoniaceae* (Begonia)

Class 11: *Kalanchoe blossfeldiana* (Flaming Katy)

Class 12: *Orchidaceae* (Orchid)

Class 13: *Spathiphyllum wallisii* (Peace Lily)

Class 14: Any other worthy specimen

**SECTION C: HANGING PLANTS**  
**“Natures Air Filters for the Home”**

Maximum container size 12”, Maximum weight 10 lbs.  
Hung from a pole with 4 hooks per pole. Plants hang 53” or 65” above the floor.  
Section limited to 12 Exhibits.

*Eligible for Grower’s Choice Award*

- Class 15: *Chlorophytum comosum* (Spider Plant)
- Class 16: *Hedera helix* (Ivy)
- Class 17: *Philodendron* and related aroids
- Class 18: Any other worthy specimen

**SECTION D: CUT FLOWERS FROM ANNUALS AND PERENNIALS**  
**“Attracting Pollinators”**

Specimen length appropriate to plant but no longer than 24”.  
One bloom for large flowers. Three blooms for small flowers.

*Eligible for an Award of Merit*

- Class 19: *Coreopsis* (Tickseed)
- Class 20: *Echinacea purpurea* (Coneflower)
- Class 21: *Gaillardia* (Blanket flower)
- Class 22: *Pentas lanceolata* (Egyptian Starcluster)
- Class 23: *Rudbeckia hirta* (Black-eyed Susan)
- Class 24: *Salvia* (Sage)
- Class 25: *Tagetes* (Marigold) – Single stem, no side shoots, Include 3 leaves
- Class 26: *Zinnia* – include 2 sets of leaves for large and medium , 1 set for small
- Class 27: Any other worthy specimen

## **SECTION E: ARBOREAL CUT FLOWERING BRANCHES**

### **“Bee Friendly”**

A single cut branch less than 30” in length.  
Include an apical tip, central leader, and several nodes. Staged in clear glass containers supplied by the flower show committee. Clear marbles may be used for ballast.

*Eligible for an Arboreal Award*

- Class 28: *Callistemon citrinus* (Bottlebrush)
- Class 29: *Cassia*
- Class 30: *Duranta erecta* (Golden Dewdrop)
- Class 31: *Erthrina herbacea* (Coral Bean)
- Class 32: *Hamelia patens* (Firebush)
- Class 33: *Jatropha*
- Class 34: *Justicia brandegeana* (Shrimp Plant)
- Class 35: *Odontonema strictum* (Firespike)
- Class 36: *Russelia equisetiformis* (Firecracker plant)
- Class 37: Any other worthy specimen

## **SECTION F: COMBINATION PLANTINGS**

### **“Together We Can Make a Difference”**

A grouping of three (3) or more botanically different plants with similar cultural requirements. Naturalistic accessories are permitted if in scale with plants and container, and theme appropriate to the plants. Maximum container size 14”. Maximum weight 20 lbs.

Each specimen must be correctly identified on a 3” x 5” card by the current scientific designation and in a manner to easily identify the specimen’s location in the container.

*Eligible for Grower’s Choice Award*

- Class 38: Dish Garden of Succulents and/or Cacti in an open low-volume shallow container
- Class 39: Planter of Herbs in an indoor or outdoor plain neutral colored container
- Class 40: Planter of Colorful Flowers and/or Foliage in an indoor or outdoor plain neutral colored container

## **DIVISION II EDUCATION**

### **“Providing Beauty and Sustenance for Earth’s Creatures”**

*Plants that are native to the region also tend to attract wildlife that is native to the region.*

*Eligible for the Educational Top Exhibitor Award*

### **EDUCATION DIVISION RULES**

1. Education Exhibits may be the work of more than one individual or organization unless a Student Judge, or an Accredited Judge is seeking exhibiting credit for preparing an education exhibit. (HB pg.29).
2. An exhibit must occupy a minimum of eighteen (18) square feet of surface area. (HB pg. 37).
3. Advanced registration with the Education Chairman, Twig Morris, 561-434-6629, [twig\\_morris@hotmail.com](mailto:twig_morris@hotmail.com) is required by April 1, 2023. (HB pg. 24)
4. Entry cards will be filled out in advance by the committee.
5. Exhibits are Competitive.
6. Scale of Points for Education Exhibits is listed in the ‘Handbook for Flower Shows’, Chapter 14.
7. Exhibits are staged on a table 6’ long X 30” wide X 29” high covered with black tablecloth.

### **EDUCATION DIVISION EXHIBITS**

#### **Exhibit 1: Growing Tropical Fruit**

Florida's climate gives home gardeners the opportunity to grow a variety of tropical and subtropical backyard fruits. Many of these are familiar such as bananas, oranges, lemons, limes, pineapple, grapefruit, dates, and figs. However, there are a wide variety of lesser-known tropical fruit varieties that are not only fun to grow but also delicious.

#### **Exhibit 2: Native Plants**

Wildlife populations are in decline because the native plants they depend on are disappearing. By adding some native plants to your garden, you can help create pollination and migration corridors for birds and insects.

## **DIVISION III YOUTH AND SPONSORED GROUPS**

### **“Starting Small”**

*One out of every three bites of food we eat exists because of pollinators like bees, butterflies, moths, birds, bats, beetles, and other insects.*

#### **YOUTH RULES**

1. The Youth Division is open to elementary grades, ages 5-10, in the Greenacres Junior Garden Club and the Wellington Boys and Girls Junior Garden Club.
2. The NGC exhibit policies are printed in the ‘Handbook for Flower Shows’, Chapter 9, exhibiting in the Youth and Sponsored Groups division. All NGC policies and rules apply.
3. All Horticulture exhibits must be grown by the exhibitor, though plants could be part of a family garden or yard.
4. Container-grown plants must have been in the possession of the youth exhibitor for a minimum of sixty (60) days.
5. Youth Exhibits are evaluated using the adult Horticulture Scales of Points.
6. The NGC Standard System of Awarding is used to judge all Youth Exhibits.
7. A minimum score of ninety (90) is required to place an NGC Youth Top Exhibitor Award.
8. Judges must consider ages and abilities of exhibitors when evaluating the exhibits.
9. All exhibits will be staged on tables 6’ long X 30” wide X 29” high covered with black tablecloths.

#### **YOUTH SECTIONS & CLASSES**

##### **Section A: Container Grown Vegetables or Herbs**

###### **“Grow Your Own”**

*Eligible for Youth Top Exhibitor Award*

Maximum container size 12”. Maximum weight 20 lbs.

Class 1: *Capsicum* (Pepper)

Class 2: *Mentha* (Mint)

Class 3: *Solanum lycopersicum* (Tomato)

Class 4: *Solanum melongena* (Eggplant)

Class 5: Any other worthy Specimen

##### **Section B: Fruits or Vegetables Grown In the Ground**

###### **“Eat More Plant Based Foods”**

*Eligible for Youth Top Exhibitor Award*

Staged on a white paper plate provided by the committee.

Suggested number per exhibit based on size: Small = 6, Medium = 3, Large = 1

Class 6: *Allium cepa* (onion)

Class 7: *Carica papaya*

Class 8: *Daucus carota* (Carrot)

Class 9: *Phaseolus vulgaris* (Bean)

Class 10: *Solanum lycopersicum* (Tomato)

Class 11: Any other worthy Specimen

## DIVISION IV BOTANICAL ARTS

### “We Only Have One Earth”

*Trees absorb carbon dioxide in the atmosphere, mitigating climate change. They reduce energy costs by shading buildings. Neighborhoods with trees are cooler than those without.*

#### BOTANICAL ARTS RULES

1. All Botanical Arts Horticulture exhibits must be grown by the exhibitor.
2. No artificial plant material is permitted in any exhibit.
3. The Scale of Points for judging Botanical Arts Horticulture is listed in Chapter 14 of the ‘Handbook for Flower Shows’.
4. The rules for Botanical Arts Horticulture are printed in the ‘Handbook for Flower Shows’, Chapter 10. (HB Pgs. 91-93)
5. All exhibits must be clearly and correctly labeled with the binomial name or currently acceptable scientific designation (genus, specific epithet and/or variety/cultivar or patented/trademarked name). Common names may also be given if known.
6. Each specimen in a Miniature landscape must be correctly identified on a 3” x 5” card by the current scientific designation and in a manner to easily identify the specimen’s location in the container.
7. Advance registration with the Botanical Arts Chairman, Carol Lazzarino 561-312-2082, [clazzar586@aol.com](mailto:clazzar586@aol.com) is required by April 1, 2023.

#### BOTANICAL ARTS SECTIONS AND CLASSES

##### Section A: Botanical Arts Horticulture

##### “Small Acts Matter”

*Classes 1-3 Eligible for Botanical Arts Horticulture Award*

**Class 1: Dried Herbs** – One bunch secured by a rubber band, string, or other fastener. Displayed on a white paper plate provided by the committee.

**Class 2: Dried and Preserved Seedpods and Cones from trees, shrubs, or cycads** - Suggested number per exhibit: small = 12, medium = 3-5, Large = 1. Displayed on a white paper plate provided by the committee.

**Class 3: Manipulated Plants** – A single plant whose natural growth has been altered by the exhibitor or someone else. Must be grown by the exhibitor for at least 6 months. Wiring is allowed. Includes espalier, topiary, grafted cacti, braided or twisted plants such as *Pachira aquatica* (money tree) and *Dracaena sanderiana* (lucky bamboo).

**Class 4: Miniature Landscape** or scene such as a Fairy Garden, Diorama, etc. All types of accessories permitted. Must contain a minimum of three botanically different plants. The plants must be grown together in the container to be exhibited for a minimum of six weeks. Containers must weigh less than 20 pounds and the container must not exceed 14” as measured across the top, staged on a table covered with a black tablecloth. Frame of reference 16 ½ inches wide by 30” deep by 29” high.

# FLOOR PLAN - DIVISION I HORTICULTURE

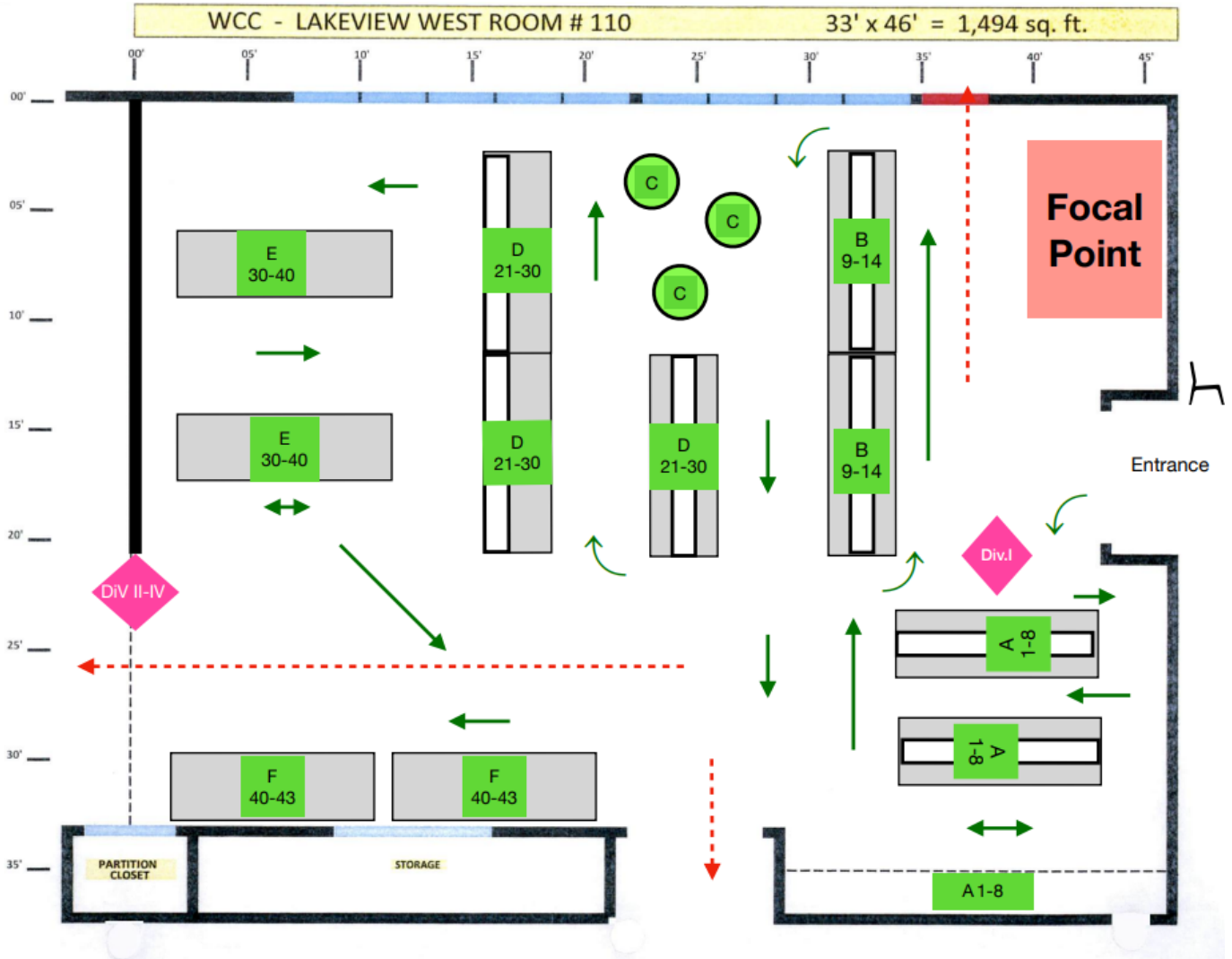

# FLOOR PLAN - DIVISIONS II, III, IV

## EDUCATION, YOUTH, BOTANICAL ARTS DIVISIONS

